

**United States Department of the Interior  
National Park Service**

**National Register of Historic Places  
Continuation Sheet**

**ELMWOOD HISTORIC DISTRICT (EAST)**

**Name of Property**

**Erie County, New York**

**County and State**

Section 10 Page 1

**VERBAL BOUNDARY DESCRIPTION**

Please refer to included maps with scale for precise boundaries. The Elmwood Historic District (East) is bounded by both sides of Summer Street and the pre-existing Allentown Historic District (NR Ref. No. 12000009) to the south. The western boundary is the centerline of Elmwood Avenue. The northern boundary is Delaware Park and Rumsey Road. The eastern boundary generally is the rear lot line of properties fronting Delaware Avenue from Summer Street to Cleveland Avenue and properties on the west side of Delaware Avenue to Rumsey Road.

**ADDITIONAL UTM<sub>s</sub>**

Point	Easting	Northing
1	673474	4755373
2	673967	4755090
3	674102	4754213
4	673575	4752364
5	673524	4752318
6	673365	4752249
7	673318	4752249
8	673254	4755290
9	673357	4755368

**BOUNDARY JUSTIFICATION**

The area of Buffalo south of North Street has long been considered a part of the Allentown neighborhood, of earlier Civil War-era settlement, and the same article also noted that streets around Virginia Street were “well settled” at the time. In an October 1902 article titled “The New Elmwood District” published in the journal *Greater Buffalo*, the boundaries of the Elmwood district were described as ranging from Delaware Street to the east, Richmond Avenue to the west, extending between North Street to the south and Lafayette Avenue (former Bouck Street) to the north.<sup>305</sup> However, as the same article also pointed out, the area north of Lafayette Street was rapidly developing, pushing the boundaries further northward. This is further corroborated by a map issued only a month later in November 1902 by *Greater Buffalo*, which visually defined the Elmwood district as covering between West Ferry Street to the south, Forest Avenue to the north, Hoyt Street to the west and Delaware Avenue to the east.<sup>306</sup> In either case, development of the new Elmwood district was focused in the late nineteenth and early twentieth centuries on an area between North Street and the parks, from Richmond Avenue

<sup>305</sup> "The New Elmwood District," *Greater Buffalo: A Monthly Publication Devoted to Promoting the Prosperity of the Power City of America*, October 1902, 8.

<sup>306</sup> "The New Elmwood District," *Greater Buffalo: A Monthly Publication Devoted to Promoting the Prosperity of the Power City of America*, November 1902, 20.

**United States Department of the Interior  
National Park Service**

**National Register of Historic Places  
Continuation Sheet**

Section 10 Page 2

**ELMWOOD HISTORIC DISTRICT (EAST)**

**Name of Property**

**Erie County, New York**

**County and State**

to Delaware Avenue. These contemporary articles define the historical boundaries of the present Elmwood Historic District.

The boundaries of the Elmwood Historic District (East) were created both from contemporary descriptions of the boundaries of the Elmwood district and also from current conditions, surveyed during the preparation of this nomination. Because of the sheer size and number of resources in the overall Elmwood Historic District, this district has been created as the East portion, lying east of Elmwood Avenue (the primary artery through this area). The boundaries for this district encompass the remaining properties in the Elmwood district, as described in the early 1900s and join the Elmwood Historic District (West) boundaries to form the complete Elmwood Historic District.

United States Department of the Interior  
National Park Service

National Register of Historic Places  
Continuation Sheet

**ELMWOOD HISTORIC DISTRICT (EAST)**

Name of Property

**Erie County, New York**

County and State

Section 10 Page 3

Elmwood Historic District (East)

City of Buffalo,  
Erie County, New York

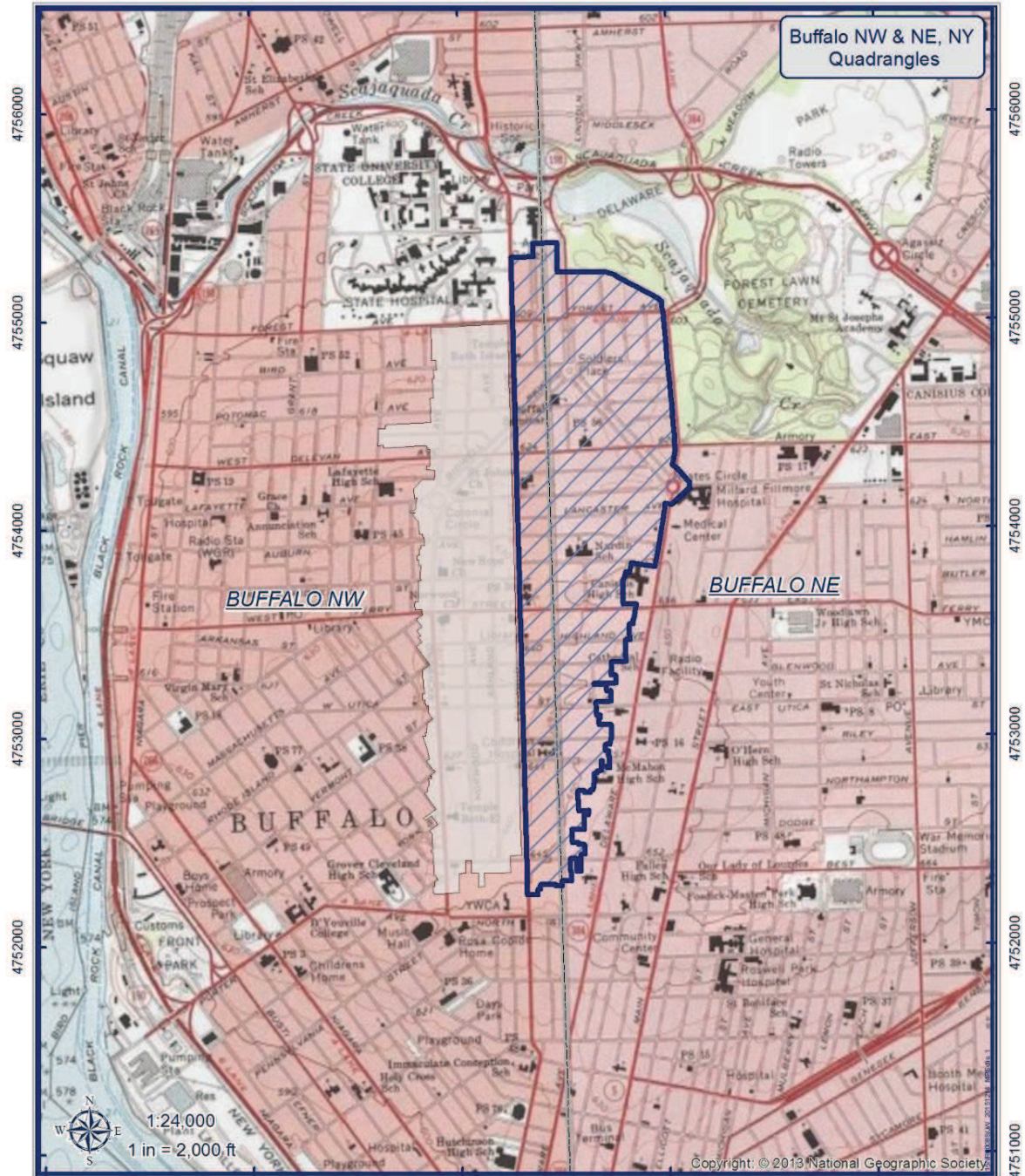

671000 672000 673000 674000 675000

4756000  
4755000  
4754000  
4753000  
4752000  
4751000

Coordinate System: NAD 1983 UTM Zone 17N  
Projection: Transverse Mercator  
Datum: North American 1983  
Units: Meter

0 5501,100 2,200 Feet

Elmwood East HD  
Elmwood West HD

NEW YORK STATE OF OPPORTUNITY  
Parks, Recreation and Historic Preservation

United States Department of the Interior  
National Park Service

National Register of Historic Places  
Continuation Sheet

Section 10 Page 4

**ELMWOOD HISTORIC DISTRICT (EAST)**

Name of Property  
**Erie County, New York**  
County and State

Elmwood Historic District (East)

City of Buffalo,  
Erie County, New York

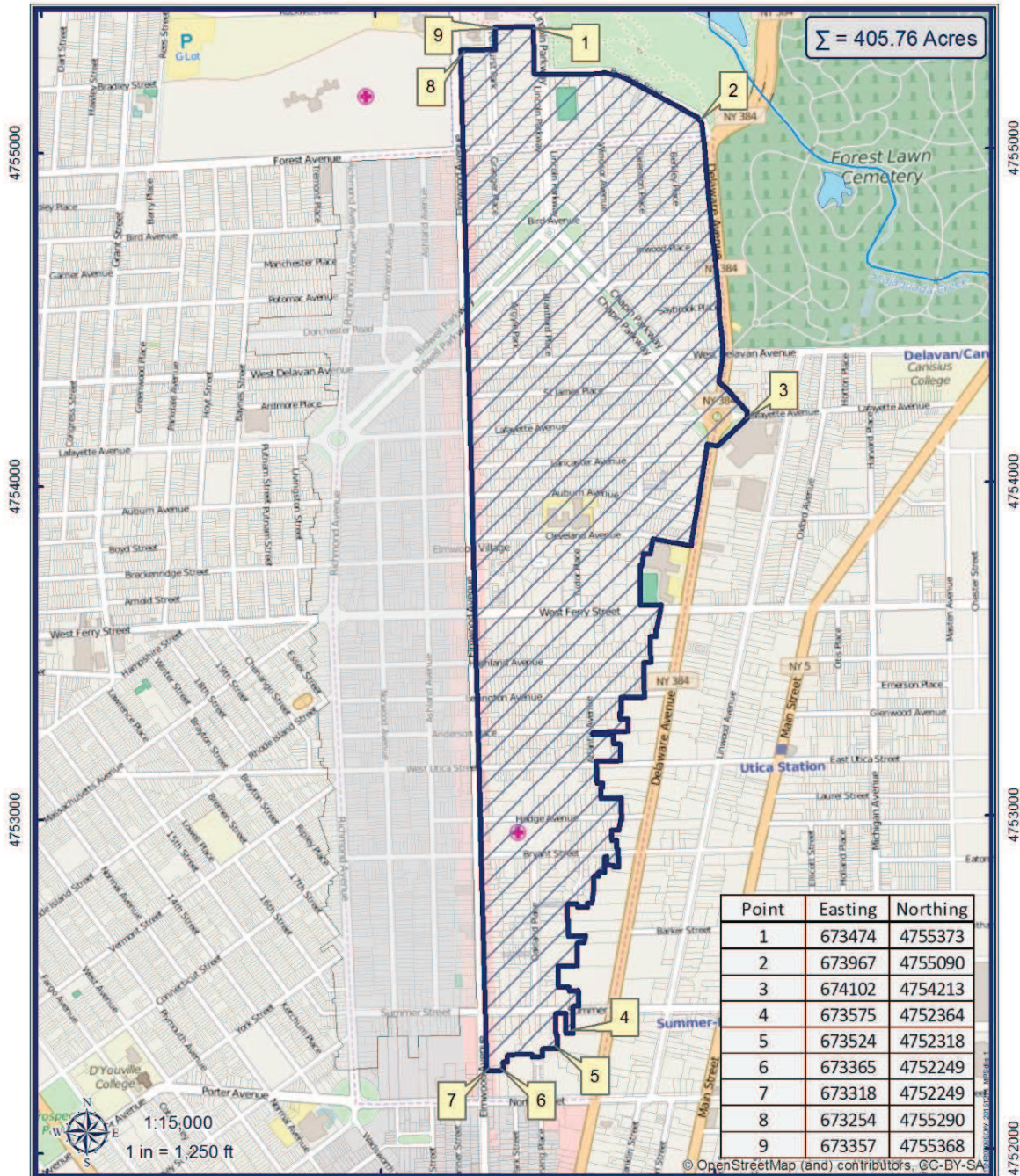

672000

673000

674000

Coordinate System: NAD 1983 UTM Zone 17N  
Projection: Transverse Mercator  
Datum: North American 1983  
Units: Meter



Elmwood East HD



Elmwood West HD



NEW YORK  
STATE OF  
OPPORTUNITY  
Parks, Recreation  
and Historic Preservation